

CT Clip



Accessory

Developed for the quick fastening of cable tray to Gripple Brackets.

FEATURES / BENEFITS

- **Secure** – prevents uplift and slide of cable tray
- **Versatile** – two sizes available to fit 2 mm and 3 mm thick steel
- **Easy** – tool-free, push fit installation
- **Quick** – two part push fit assembly saves time on the install, when compared to traditional methods



INSTALLATION

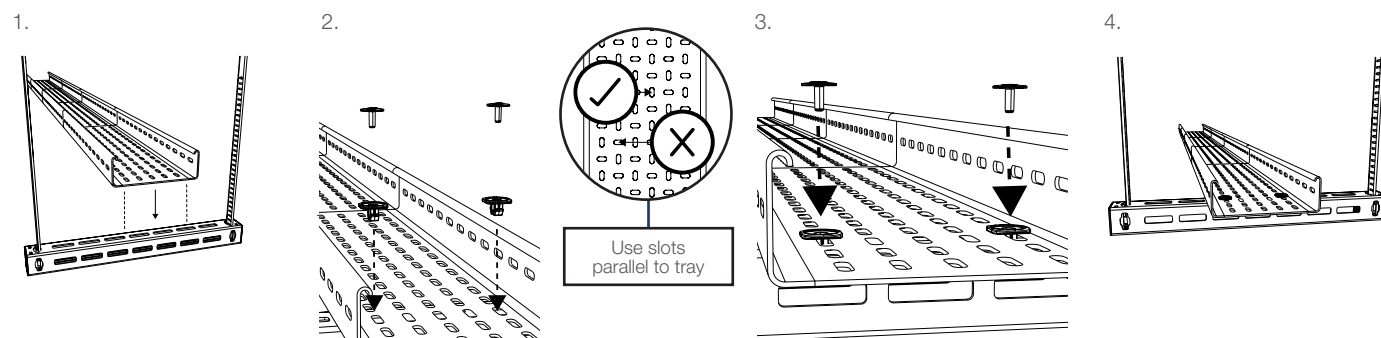

SPECIFICATION

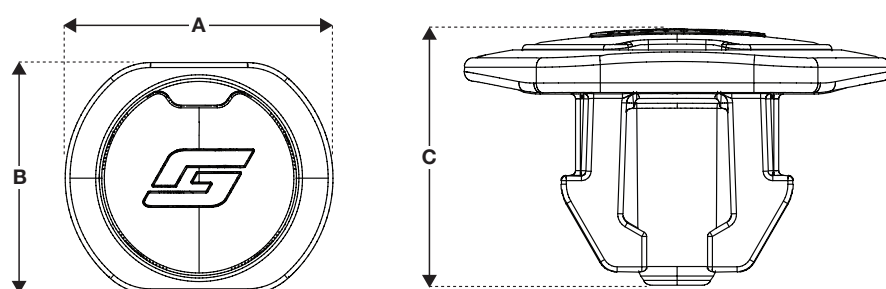

GREY (2 mm steel thickness)		
A (mm)	B (mm)	C (mm)
22	19	13

BLACK (3 mm steel thickness)		
A (mm)	B (mm)	C (mm)
22	19	13

RELATED PRODUCTS

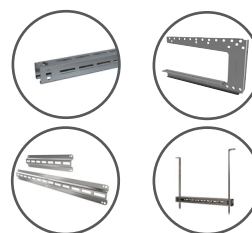

For more options on related products please
contact us or visit **www.gripple.com**

SUBMITTAL INFORMATION

Safe Working Load:

Non load bearing

Material:

Acetal Copolymer (POM C) (ERCACETAL C)

Colour

Grey - suits 2 mm perforated steel tray
Black - suits 3 mm perforated steel tray

